

PROPOSED SECOND FLOOR PLAN
1/4" = 1'-0" 1340 SF

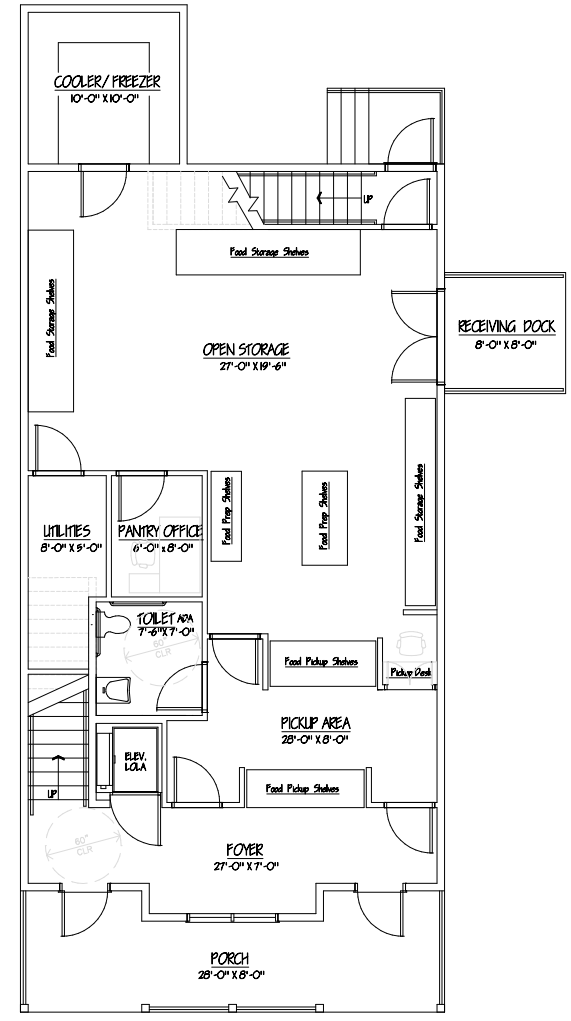

FRONT ELEVATION
1/4" = 1'-0"

PROPOSED BUILDING	
First Floor	1444 SF
Second Floor	1344 SF
Total Square Footage	2788 SF



PROPOSED FIRST FLOOR PLAN
1/4" = 1'-0" 1440 SF

R. C. D. ARCHITECTURAL PLANNING
 1. Concept, Schematic Design, Working
 2. Construction Documents
 3. Construction Administration
 Raymond C. Smith, AIA
 100 Main St., Suite 101
 Hillsborough, NH 03043
 603-479-5489

HILLSBOROUGH FOOD PANTRY
 CHURCH STREET
 HILLSBOROUGH, NH

PROPOSED PLANS & ELEVATION
 1/4" = 1'-0"
 DATE: 05/17/08
 Drawing No. P-1

REVISIONS

DRAWING NO.
P-1

Red: January, 2008 5:19:08 PM 12:49:22 AM EST